



QP-Series Powered Mixers

QP475, QP8200
(178.730, 178.732)

User Manual



Features:

- Integral USB media player
- Digital Delay Effect
- Bass +Treble EQ for each channel
- +15V phantom power
- 5-band master EQ

Introduction:

Thank you for choosing the QTX Sound QP-series powered mixer. This compact, feature-laden unit has many different settings and varied applications. Please read this manual before using this equipment in order to avoid damage through incorrect operation and to get the best performance from your purchase.

Warning:

To prevent the risk of fire or electric shock, do not expose any of the components to rain or moisture.

If liquids are spilled on this unit, stop using immediately, allow unit to dry out and have checked by qualified personnel before further use.

Avoid impact or heavy vibration to any of the components.

No user serviceable parts inside - refer all servicing to qualified service personnel.

Safety

- Make sure that the mains lead used is not damaged and is adequately rated for the power consumption of the unit.
- Check that the voltage selector is switched to the same voltage as the mains supply
- Ensure speakers are connected using adequately rated speaker jack leads (not signal jack leads) and that the total load is no lower than 4Ω
- Turn down the MASTER volume when switching on or off, connecting equipment or engaging phantom power.

Placement

- Keep out of direct sunlight and away from heat sources.
- Do not cover or obstruct cooling vents
- Position the unit in a safe, stable place during operation
- Keep away from damp or dusty environments.
- Clear debris from fan vents regularly (with mains off)

Cleaning

- Use a soft cloth with a neutral detergent to clean the unit
- Lightly damp sterile wipes may be used on the microphone grille for hygiene purposes
- To avoid damage, do not use solvents to clean the components

Front Panel

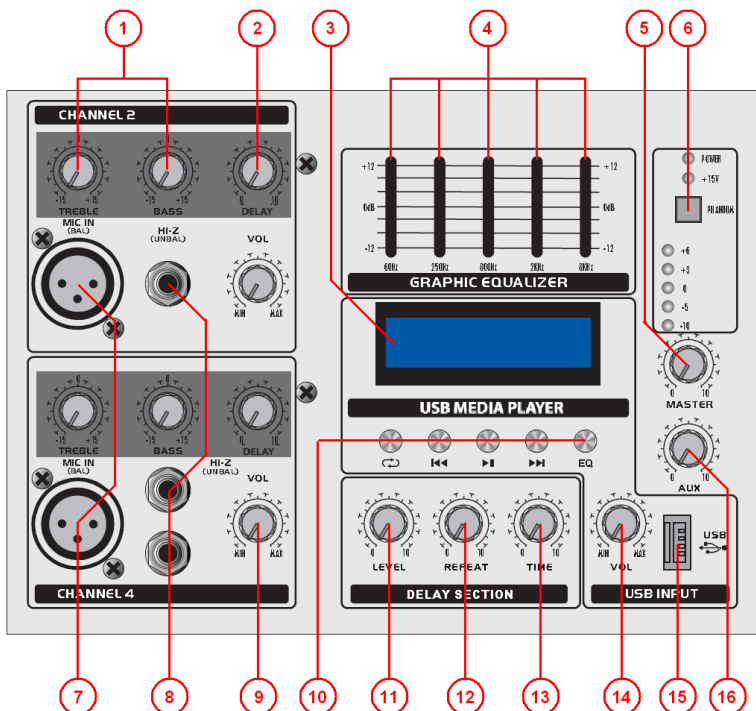

1. BASS + TREBLE – EQ adjustment for high and low frequencies
2. DELAY – adjust delay effect level for channel
3. LCD display – Backlit display for USB player
4. Master EQ – 5-band graphic equalizer for main output
5. MASTER – main output level control
6. Phantom – +15Vdc to XLR for condenser mics
7. MIC IN – XLR input for microphone
8. HI-Z (UNBAL) – high impedance line input jack
9. VOL – channel volume adjustment
10. USB MEDIA PLAYER – transport & EQ controls
11. Delay LEVEL – global delay effect adjustment
12. Delay REPEAT - delay regeneration control
13. Delay TIME adjustment
14. USB VOL – media player level control
15. USB INPUT – USB connector for memory device
16. AUX – level control for rear AUX input (RCA)

Rear Panel

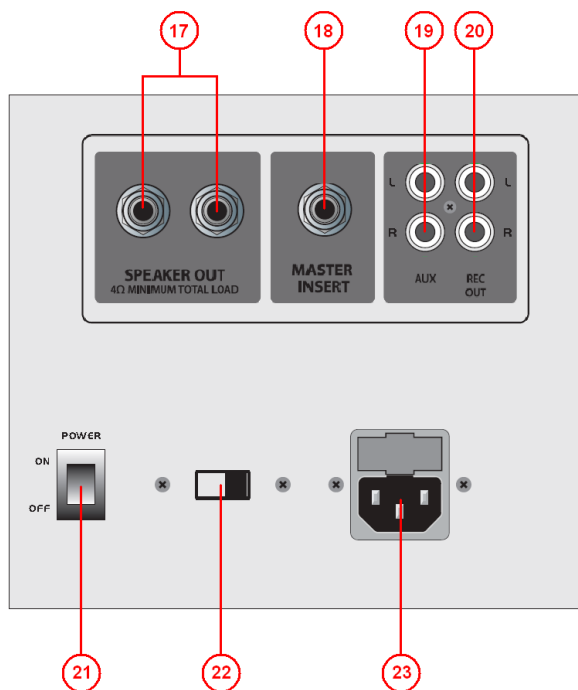

- 17. SPEAKER OUT – 6.3mm jack output for 2 x 8Ω speakers
- 18. MASTER INSERT – 6.3mm TRS jack insert for overall mix
TIP – Return / RING – Send / SLEEVE – Earth
- 19. AUX – L+R (summed to mono) RCA auxiliary line input
- 20. REC OUT – L+R (parallel mono) RCA record level output
- 21. POWER – On/Off mains switch
- 22. 115/230V – mains voltage selector
- 23. MAINS inlet – IEC with integral mains fuse

Connection

Connect speaker cabinet(s) to SPEAKER OUT jack(s) on the rear panel, ensuring that the overall load is no lower than 4Ω (note: 8Ω+8Ω=4Ω) and that the combined power handling of the speakers is not exceeded by the amplifier's rated output (200Wrms - QP8200, 75Wrms - QP475).

With the POWER switch in the "off" position and MASTER turned fully down, connect power to the unit via the IEC mains lead, ensuring that the lead is in good condition and that the voltage selector (rear panel) is the same as the mains supply.

Connect microphone(s) to the XLR channel input(s) and switch on +15V phantom power if required (for example - condenser microphones). Connect line level sources (MP3 players, CD players, electronic keyboards etc.) via the HI Z (high impedance) input jacks and auxiliary line input to the AUX RCA inputs on the rear panel.

If external EQ or dynamics processors are to be used, these can be connected via the MASTER INSERT jack on the rear panel using a stereo to 2 x mono jack lead. This 6.3mm jack has 3 connections as shown below...

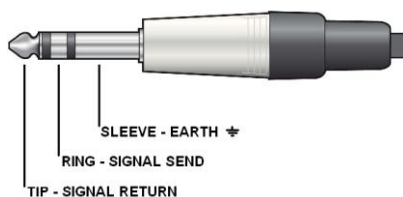

For the digital audio player, plug a USB pen drive into the USB connector on the front panel. This will need to have compressed digital audio stored on it for playback.

To record the overall mix or as an extra line output, connect the REC OUT to the input of the external equipment via a twin RCA lead.

Operation

Switch on the POWER at the rear panel and check that the power LED on the front is illuminated. Ensure channel volumes, AUX, USB and delay level controls are turned down and gradually turn up the MASTER volume control to roughly half way.

To test each channel input, with BASS and TREBLE controls at the 12 o'clock position, gradually increase the channel volume and speak into the microphone or play the line level source until the sound can be heard through the speaker cabinets. Adjust BASS and TREBLE controls to the desired low and high frequency content of the channel.

For auxiliary line input, play the audio from the source and gradually increase the AUX control to check that the sound is produced through the speakers.

Check the USB input by gradually increasing the VOLUME control positioned next to the USB connector. Check the LCD display to see the media type and player status. See below for the functions of the transport controls...

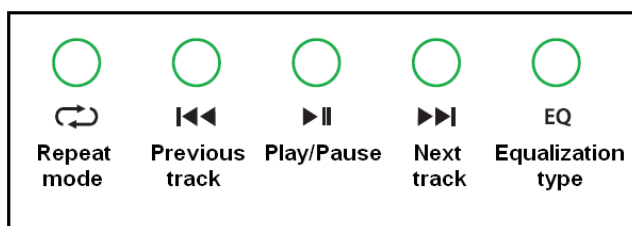

For internal delay effect, turn up the LEVEL control in the delay section and dial in the DELAY control for each channel as required, adjusting TIME and REPEAT controls to produce the desired type of echo or repeat effect.

Adjust overall volume via the MASTER control and the overall tone can be adjusted from the 5-band graphic EQ section. These sliders affect (from left to right) low, low-mid, mid, mid-high and high frequencies to help balance the tone of the overall output.

Specifications

	QP475	QP8200
Power supply	115 / 230W, 50 / 60Hz (IEC)	
Input Impedance	Mic - bal	2kΩ
	Mic - unbal	1kΩ
	Line	10kΩ
	RCA inputs	47kΩ
Channel EQ	Treble	±12dB @ 10KHz
	Bass	±12dB @ 100Hz
Master EQ	60Hz	±12dB
	250Hz	
	600Hz	
	2kHz	
	8kHz	
Frequency Response	20Hz-20KHz +1dB/-3dB @ 1W Output to 8 Ohm Speaker	
THD	<1% fully driven into 4Ω load	
Max Power Output	785W @ 4Ω	200W @ 4Ω
Power Consumption	120W	320W
Dimensions	319 x 247 x 198mm	463 x 247 x 198mm
Weight	6.8kg	9.7kg

Troubleshooting

"POWER" LED does not light on receiver	Ensure mains lead is connected to mains and voltage selector is same as mains supply
	Ensure POWER is switched on
	Check Plug-top fuse and mains fuse in IEC inlet are both OK
"POWER" LED is lit but no signal LEDs illuminating	Check input source and connection cable work (using a different mixer or amplifier)
	Ensure MASTER and channel VOL levels are not turned fully down
	For condenser microphones, check that +15V phantom power is switched on
	Unplug MASTER INSERT and check if wired correctly and connected equipment is working.
LEDs are lit but no sound through speakers	Check speaker leads are OK and connected properly
	Check speakers are working properly (using a different mixer/amplifier)
USB player will not play digital media files	Check file format is a standard compressed type – certain formats may not be recognised
	Check if USB pen drive is damaged or data is corrupted (try a different USB pen)
	Check LCD display for status and use transport controls to navigate through files
	Ensure that VOL control next to USB input is turned up
Output is distorted or very loud	Check that line level source is not connected to an XLR input
	Reduce channel VOL, TREBLE and BASS controls if set too high
Feedback (loud squealing or howling) from speakers	Ensure microphones are not pointed towards the speakers
	Reduce VOL, TREBLE or BASS for microphone input(s)
	Reduce DELAY level on microphone inputs
	Try to eliminate feedback by reducing particular sliders on the Graphic Equalizer
Output is very low	Turn up MASTER volume and/or channel VOL controls
	Turn up AUX or USB VOL controls
	Ensure Graphic Equalizer sliders are not set too low
	Check level on any equipment connected to MASTER INSERT isn't set too low

Note: for further troubleshooting, refer equipment to qualified service personnel for testing

www.qtxsound.com

© QTX Sound 2011