

# High Power LED Par cans

## User manual

153.781UK, 153.782UK, 153.784UK, 153.785UK, 153.787UK, 153.788UK, 153.790UK, 153.791UK  
Version 1.0

**HIGH POWER LED PAR CANS: For indoor use only**



**CAUTION! Please read this manual carefully before operating! Pay special attention to Sections 3 & 5 of this document.**

**1. General introduction :**

These high power LED Par cans have been designed for a whole different variety of applications. From stages, night clubs, theaters to exhibition displays these par cans will not fail to deliver. They have been designed for trouble free installations and setups. There are 4 different models (see below) each available in both a black and chrome finish. All of the functions are fully explained in this manual. Please read on for more information:

- Par 56 24 x 1W (RGB) : Spot type light effects with RGB colour mixing
- Par 64 36 x 1W (RGB)
- Par 64 36 x 3W (RGB): Higher power LED par can for use where more light needs to be projected over a longer distance.
- Par 64 24 x 3W 3in1 : Designed to give a more consistence light (Tri col) output and richer colours.

We recommend that all these products are used within the guidelines HSG95

**15. Technical specification :**

Voltage 100-240Vac, 50/60Hz  
 LED Life: 50,000 Hours  
 DMX Channels: 6

Technical Data	Size	Colour	Power Consumption	LED Type	LED Qty	Beam Angle	Light Projecting Distance	Dimensions	Weight
151.785UK	Par 56	Black	30W	1W	24 (R:8, G:8, B:8)	25° -	10 - 15m	195 x 195 x	2.2kg
151.785UK		Chrome						235mm	
151.784UK		Black	45W		36 (R:12, G:12, B:12)	30°	20 - 25m	245 x 245 x	3.20kg
151.785UK		Chrome							
151.787UK	Par 64	Black	115W	3W			10-15m		
151.785UK		Chrome							
151.790UK		Black	90W	3W Tri colour	24 Tri colour	45°			3.20kg
151.791UK		Chrome							

Note: Conforms to Laser and LED Safety standard BSEN60825-1 2007

**13. DMX controlling :**

Channel	Function	Value
1	Red 0-100% Dimming	000-255
2	Green 0-100% Dimming	000-255
3	Blue 0-100% Dimming	000-255
4	Blackout	000-010
	Master dimmer 0-100%	011-249
	Full 100%	250-255
5	000-010 No strobe	000-010
	011-255 Strobe slow to fast	011-255
	Auto mode speed control slow to fast ( when CH6 DMX is between value 011-138)	000-255
6	Off	000-010
	Auto Colour Switch	011-045
	Auto Colour Pulse	046-090
	Auto Colour Scroll	091-138
	Sound to light	139-195
	Sound to light Strobe	196-255

**14. Disposal :**



Please disposal of the unserviceable device according to the current statutory requirements.

**2. Package contents:**

Please check the contents to ensure that the product has been received in good condition.

Light x 1unit	IEC Power Lead x 1	User's Guide x 1pcs
---------------	--------------------	---------------------

If you find any accessory is missing or the lighting has arrived with any problems, please contact your local dealer at once. This product contains no serviceable parts to make no attempt to try to fix or modify this item yourself as you may invalidate the warranty. We recommend you keep the original package and proof of purchase for any possible replacement or returned demand.

**3. Installation :**

This product is for professional use only and every person involved with the installation, operation and maintenance of this device should be qualified and follow the instructions of this User Guide. We recommend that this product is not used for audience scanning and should be used within the guidelines of radiation of lasers used for display purposes "HSG95". (copies of the guidance can be downloaded from the HSE website

<http://www.hse.gov.uk/pubns/priced/hsg95.pdf>

When you connect to the main power supply the device will illuminate and the light effect will change with music when in sound activated mode.

**Code Description (RGB Versions):**

A001 - A512	DMX-512 Address from 1 to 512
Er_L	If there is a breakdown in the DMX connection
AUT1	Auto colour switch mode
AUT2	Auto colour slow fade in – hold - slow fade out
AUT3	Auto colour scroll. Colours change while maintaining the brightness
P000	Set the time limit between each colour change 000 = 128 seconds, 255 = 0.5 seconds
SOU1	Sound to Light mode – Colours change to beat of the Music
SOU2	Sound to light strobe – Light effect strobes to the beat of the music
S000	Microphone sensitivity 0 - 100%
MAN	Manual colour select
RED	Select red brightness 0-255 (0 = 0% 255 = 100%
GREE	Select green brightness 0-255 (0 = 0% 255 = 100%
BLUE	Select blue brightness 0-255 (0 = 0% 255 = 100%
SLA	Slave mode

**12. Functions guide:**

**Button operation (from left to right):**

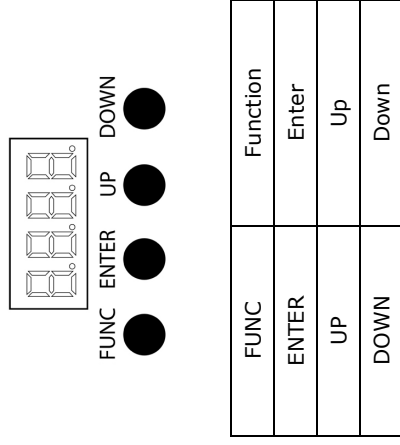

**Code illustration:**

SOU	Sound to light mode
AUT	Auto mode
A001	DMX Address (1 - 512)
MAN	Manual colour select
SLA	Slave mode

Press the "FUNC" button to select which mode you require. Press "UP" and "DOWN" until you reach the desired option. Press "ENTER" to confirm.

Select the sub option by pressing "UP" and "DOWN" and then "ENTER" to confirm



**4. Mounting instruction :**

The fixture may be mounted in any position provided there is adequate room for ventilation. It is important never to obstruct the fan or vent pathway. Mount the fixture using a clamp. Unscrew the safety screws underneath the device and fix a G-Clamp to the fixture. After finding desired position tighten the G-Clamp. When selecting installation location, take into consideration routine maintenance. Safety cables must always be used. Never mount in places where the fixture will be exposed to rain, high humidity, extreme temperatures changes or restricted ventilation. The product should be securely mounted so that its output emission is always directed away from people and at objects that are able to reflect emission in a hazardous direction. In this regard, the separation distances cited in HS(G)95 should be observed.

**5. Caution :**

For your safety, please kindly pay attention to all of the warnings below:

- Always plug in the power plug last and disconnect from the mains, when the device is not in use or before cleaning.
- Do not install and operate the device in rain or extreme heat, moisture or dusty environments.
- This device is for indoor use only and in a dry environment.
- Do not switch on immediately but wait until it reaches room temperature, if the device has been exposed to drastic temperature fluctuations.
- Do not shake the device and avoid brute force when installing or operating



- Do not use the device during thunderstorms and please disconnect the power.
- Do not use solvents or aggressive detergent to clean the device. Use a soft and clean cloth.
- Do not modify the device or the connected power cord without authorization.
- Use appropriate safety-rope.
- Do not stare into the light, this product emits hazardous levels of optical radiation and will cause serious injury to the eyes if viewed at close range.
- This product should be securely mounted so that its output emission is always directed away from people and at objects that are able to reflect emission in a hazardous direction. In this regard, the separation distances cited in HS(G)95 should be observed.
- The symbol  determines the minimum distance from lighted objects. The minimum distance between light-output and the illuminated surface must be more than 0.5m.

**1.1. Rear display:**

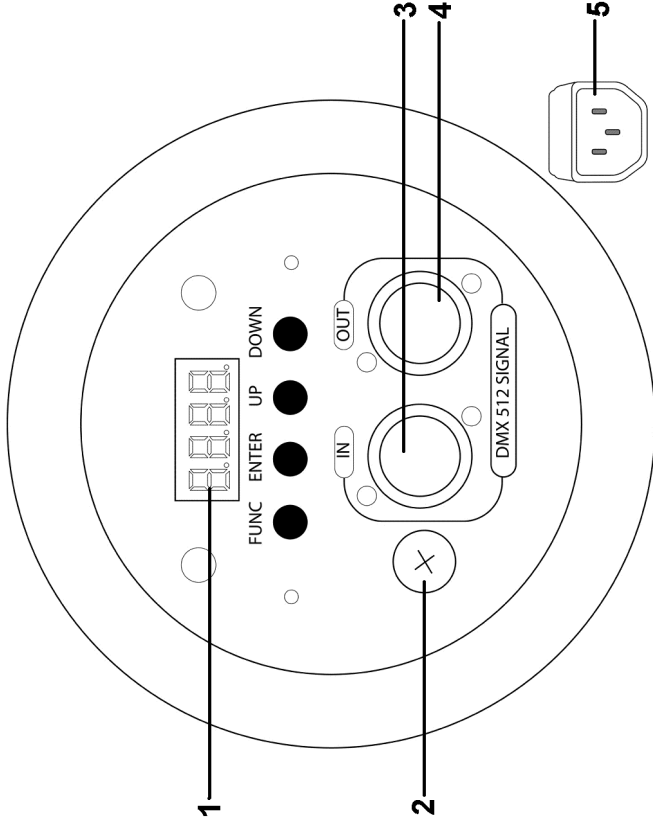

1. Digital controller
2. Fuse holder
3. DMX IN
4. DMX OUT
5. IEC Input from power lead

**10. Layout:**

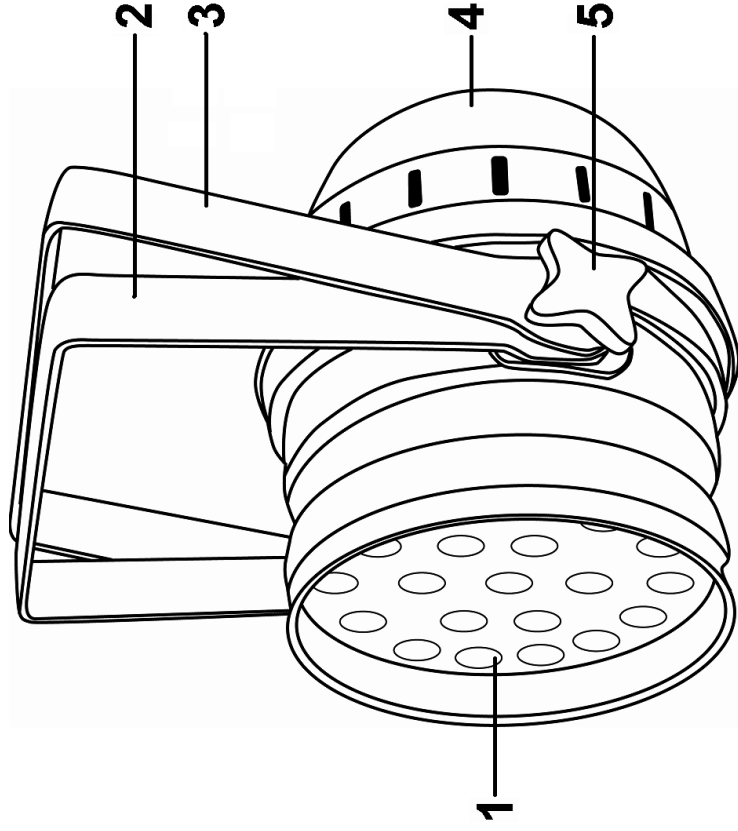

1. LED Lens
2. Secondary bracket
3. Primary bracket
4. Housing
5. Thumb screw

**6. Connect with power supply:**

Use the plug to connect to the main power supply as following.

Line	Connection	International signal
Brown	Live	L
Blue	Neutral	N
Yellow /Green	Earth	E

**7. Replacing fuse :**

Disconnect from the main power supply first, then remove the fuse from the IEC Socket or fuse holder . Replace with a fuse of the correct rating as stated on product label or user guide.

**8. General maintenance :**

To maintain optimum performance and minimize wear, fixtures should be cleaned frequently. Usage and environment are contributing factors in determining frequency. As a general rule, fixtures should be cleaned at least twice a month. Dust build-up reduces light output performance and can cause overheating. This can lead to reduced lamp life and increased mechanical wear. Be sure to power off fixture before conducting maintenance. Unplug fixture from power. Use a vacuum or air compressor and a soft brush to remove dust collected on external vents and internal components. Clean all glass when fixture is cold with a mild solution to the cloth or tissue, and drag dirt and grime to the outside of the lens. Gently polish optical surface until they free of haze and lint.

The cleaning of internal and external optical lenses and/or mirrors must be carried out periodically to optimize light output. Cleaning frequently depends on the environment in which the fixture operates: damp, smoky or particularly dirty surroundings can require cleaning fluid. Always dry the parts carefully. Clean the external optics at least every 20 days.



**9. Quick trouble shooting :**

7.1 If the unit does not function – Check that the main power is on and the fuse is intact.

7.2 If the unit is not reacting to music – check the unit is in “sound to light” mode and that the sensitivity control is fully clockwise.

7.3 If the product is not reacting to DMX signals, check the cables and connections

